

## Please Read before Proceeding

- If the security lock is on, deactivate it. After work is complete, activate the security lock again.
- Before cleaning the magnetic head, make sure that you clean the cleaning roller. Otherwise, dirt on the cleaning roller may be attached to the cleaning card, causing its cleaning capability to deteriorate.
- After cleaning is complete, check to ensure that all dismantled parts are restored to their original positions. Failure to restore the parts may result in malfunction of the printer.
- Do not perform any work on the printer door. Do not place heavy objects or apply load on the printer. Doing so may damage it.
- For details on separately sold items, please consult our authorized dealers.
- Replace the magnetic head cleaning card accordingly if it has become dirty. Using a dirty card may dirty the head and cause malfunction.

## Maintenance of Magnetic Head



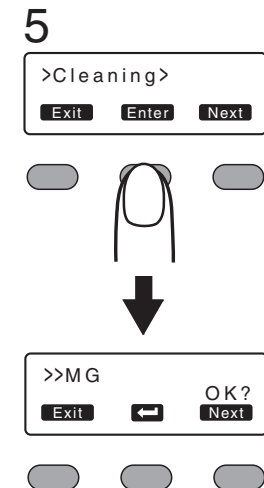
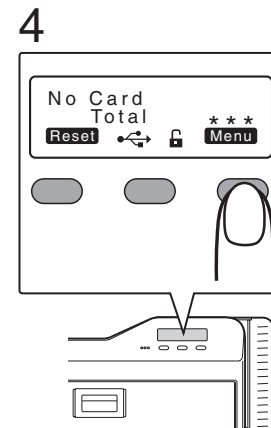
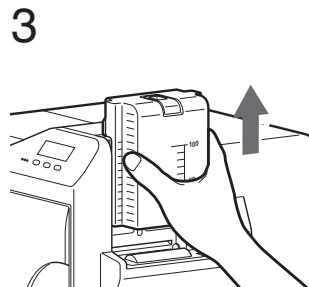
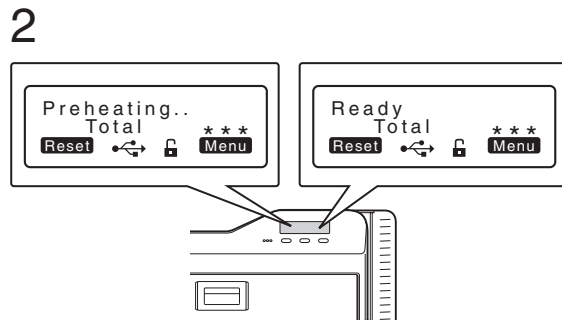
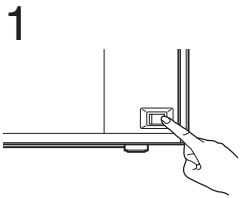

If the magnetic head is dirty, errors may occur during writing to or reading of the magnetic stripe card. Clean the magnetic head after approximately every 1,000 cards.

1. Turn on the power
2. Check to ensure that [Ready] or [Preheating..] is displayed on the operation panel of the printer
3. Remove the card hopper
4. Press **Menu** to set to [Cleaning]
5. Press **Enter** → **Next** to set to [MG]



## Please Read before Proceeding

- If the security lock is on, deactivate it. After work is complete, activate the security lock again.
- Before cleaning the magnetic head, make sure that you clean the cleaning roller. Otherwise, dirt on the cleaning roller may be attached to the cleaning card, causing its cleaning capability to deteriorate.
- After cleaning is complete, check to ensure that all dismantled parts are restored to their original positions. Failure to restore the parts may result in malfunction of the printer.
- Do not perform any work on the printer door. Do not place heavy objects or apply load on the printer. Doing so may damage it.
- For details on separately sold items, please consult our authorized dealers.
- Replace the magnetic head cleaning card accordingly if it has become dirty. Using a dirty card may dirty the head and cause malfunction.

6. Apply alcohol on the magnetic head cleaning card (sold separately)
  - Apply about three to four drops of alcohol on the position of the magnetic stripe.
7. Press 
8. Insert the magnetic head cleaning card within 20 seconds
  - Insert the card within 20 seconds after pressing .
  - After pressing , the buzzer sounds upon a lapse of 20 seconds, and a [Jam(Hopper)] error message appears about 10 seconds later. Press **Reset** →  to cancel the error.
9. After the cleaning card is discharged, turn off the power, and install the card hopper
  - To turn on the power again, do so after an interval of at least 10 seconds.

