

## Please Read before Proceeding

- If the security lock is on, deactivate it. After work is complete, activate the security lock again.
- Before cleaning the card feed roller and heating roller, make sure that you clean the cleaning roller. Otherwise, dirt on the cleaning roller may be attached to the cleaning card, causing its cleaning capability to deteriorate.
- Stand the cassette on a flat surface as illustrated in the diagram. Avoid doing so on the floor as dust attached to it may cause printing errors.
- If card jam occurs when the cleaning card is inserted, turn off and on the power of the printer. Doing so automatically discharges the card.
- Do not perform any work on the printer door. Do not place heavy objects or apply load on the printer. Doing so may damage it.
- Each cleaning card can only be used once. Reusing a dirty card may dirty the roller or cause the printer to malfunction.
- After cleaning is complete, check to ensure that all dismantled parts are restored to their original positions. Failure to restore the parts may result in malfunction of the printer.
- For details on separately sold items, please consult our authorized dealers.

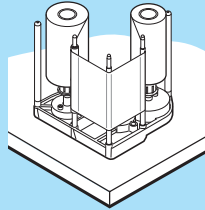

## Maintenance of Card Feed Roller/Heating Roller

The color of the printed card may appear faded or dirt may appear conspicuous if the card feed roller or heating roller is dirty.

Perform cleaning after printing about 1,000 cards.

1. Open the printer door. Press and hold down the cassette button, and remove the retransfer film cassette (on the left)
2. Close the printer door
3. Remove the card hopper
4. Turn on the power
5. Press **Menu** to set to [Cleaning]
6. Press **Enter** to set to [Rollers]
7. Press **←**
  - A [Film Checking..] message appears, followed by a [Cleaning Start OK?] message.
8. Peel off the backing paper from the cleaning card (sold separately)

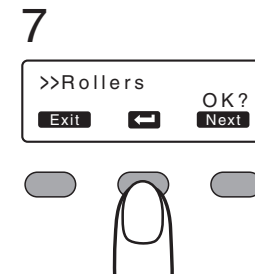
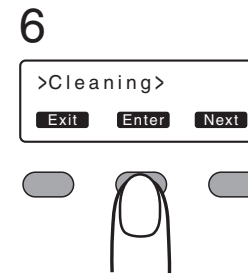
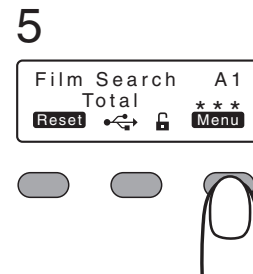
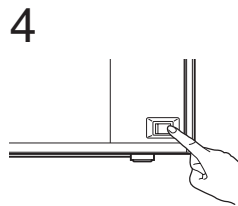
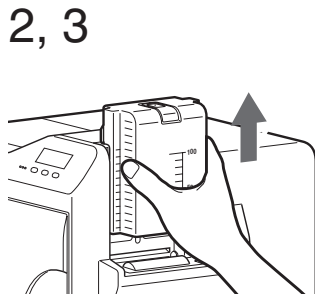
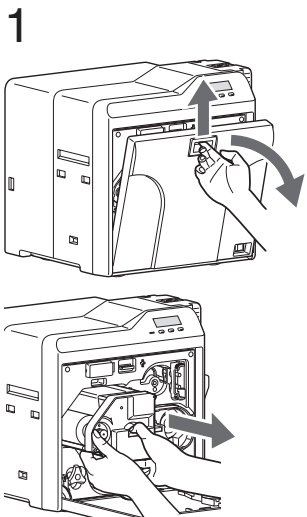

## Please Read before Proceeding

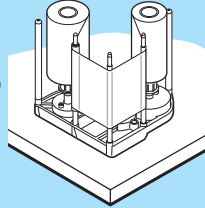

- If the security lock is on, deactivate it. After work is complete, activate the security lock again.
- Before cleaning the card feed roller and heating roller, make sure that you clean the cleaning roller. Otherwise, dirt on the cleaning roller may be attached to the cleaning card, causing its cleaning capability to deteriorate.
- Stand the cassette on a flat surface as illustrated in the diagram. Avoid doing so on the floor as dust attached to it may cause printing errors.
- If card jam occurs when the cleaning card is inserted, turn off and on the power of the printer. Doing so automatically discharges the card.
- Do not perform any work on the printer door. Do not place heavy objects or apply load on the printer. Doing so may damage it.
- Each cleaning card can only be used once. Reusing a dirty card may dirty the roller or cause the printer to malfunction.
- After cleaning is complete, check to ensure that all dismantled parts are restored to their original positions. Failure to restore the parts may result in malfunction of the printer.
- For details on separately sold items, please consult our authorized dealers.



### 9. Press

- A [Cleaning...] message appears.
- If the retransfer heating roller is hot, a [HR is too hot!] message will be displayed. Turn off the power, and perform cleaning after the retransfer heating roller has cooled down completely.

### 10. Insert the cleaning card (sold separately) within 20 seconds

- The roller draws in the card, and cleaning starts automatically.
- A [Cleaning Start OK?] message appears after the card is discharged.
- Insert the card within 20 seconds after pressing .
- After pressing , the buzzer sounds upon a lapse of 20 seconds, and a [Jam(Hopper)] error message appears about 10 seconds later. Press **Reset** →  to cancel the error.
- When a standard-sized card is inserted, the card is automatically discharged from the NG card outlet, and a [Cleaning Start OK?] message appears.

### 11. Press , and insert the cleaning card again

- Reverse the adhesive face, and insert the card.

### 12. After the cleaning card is discharged, turn off the power, install the retransfer film cassette, close the printer door, and install the card hopper

- To turn on the power again, do so after an interval of at least 10 seconds.

9



10

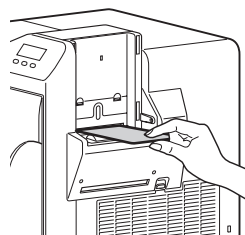

11



12

